

# THE BUTTERCUP

3 BEDROOM  
2 BATH  
3,184 SQ.FT.\*

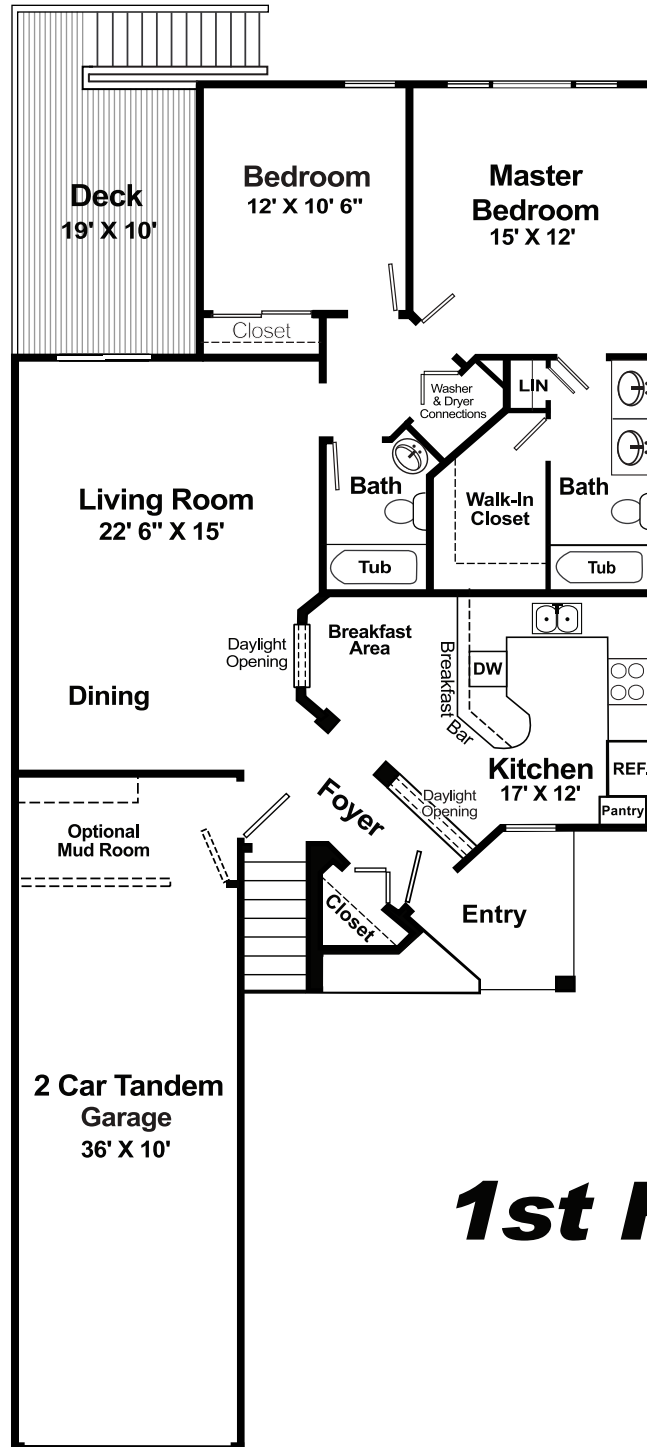

## 1st Floor

The Prairie Wind Townhomes of Lake Geneva, LLC. policy of continual attention to design and construction requires that all specifications, designs, material and equipment, dimension, landscaping, methods, prices and other criteria are subject to change without notice. \*Sq. footage includes balcony, garage & lower level.

1150 Park Drive, Lake Geneva, Wisconsin 53147 - Office 262-248-2920  
[www.prairiewindtownhomes.com](http://www.prairiewindtownhomes.com)

Updated 2/21/06  
Buttercup Floor Plan - 1st