

THE CHAPARRAL

3 BEDROOM
2 BATH
2,294 SQ.FT*

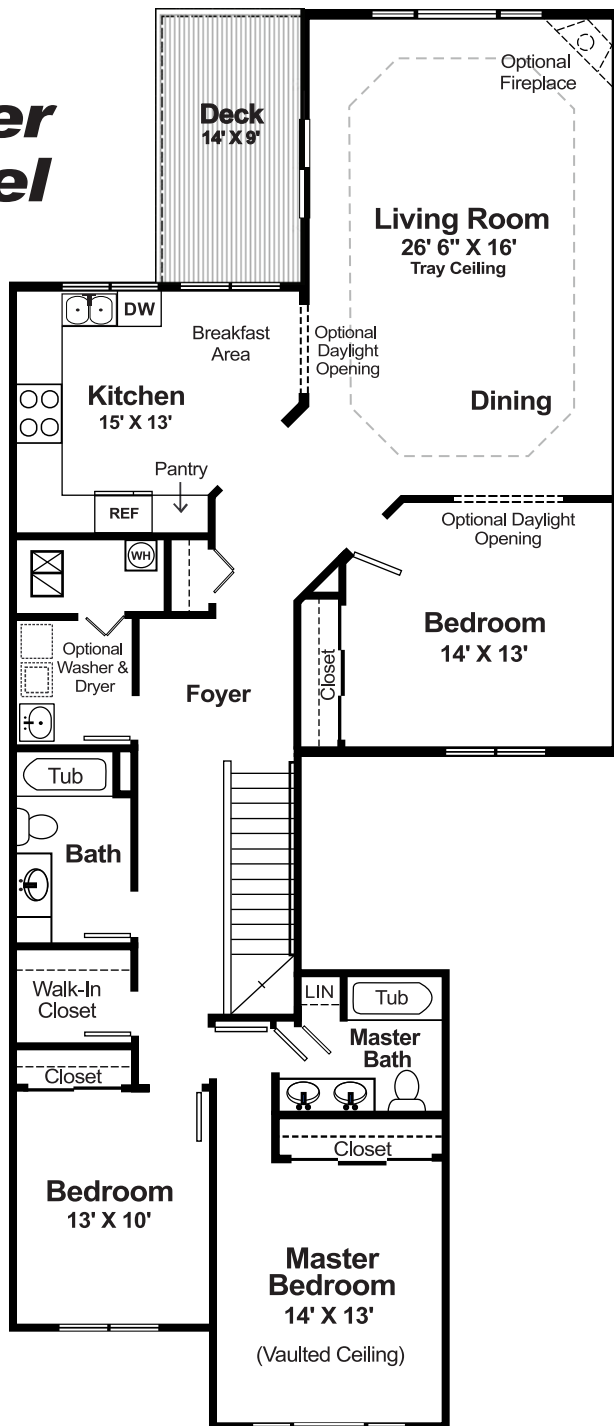

Upper Level



1st Floor

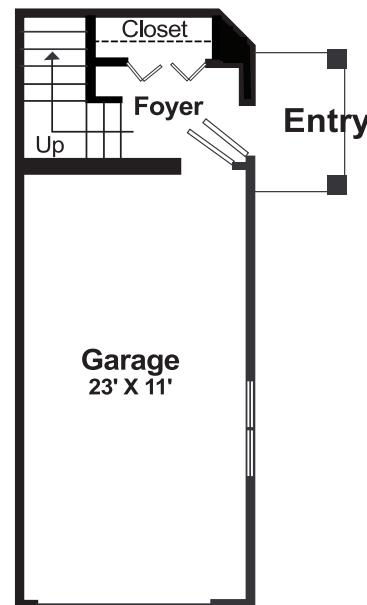

The Prairie Wind Townhomes of Lake Geneva, LLC. policy of continual attention to design and construction requires that all specifications, designs, material and equipment, dimension, landscaping, methods, prices and other criteria are subject to change without notice. *Sq. footage includes balcony, garage & lower level.

1150 Park Drive, Lake Geneva, Wisconsin 53147 - Office 262-248-2920
www.prairiewindtownhomes.com

Updated 2/21/06
Chaparral Floor Plan